

**FRYPOT AND BURNER  
INSULATION BREAKDOWN  
FOR  
BIGLA30 AND FPGL30  
SERIES FRYERS**

**FOR USE WITH KITS  
826-2595, 826-2596, 826-2592, and 826-2593**

\* 8196419\*<sup>SEP 2009</sup>

Kit 826-2595 contains Items 7, 9-19 and 31 (all shown shaded in table).

Kit 826-2592 contains the insulation and gaskets required when replacing burners only (Items 10, 14, 16 and 31).

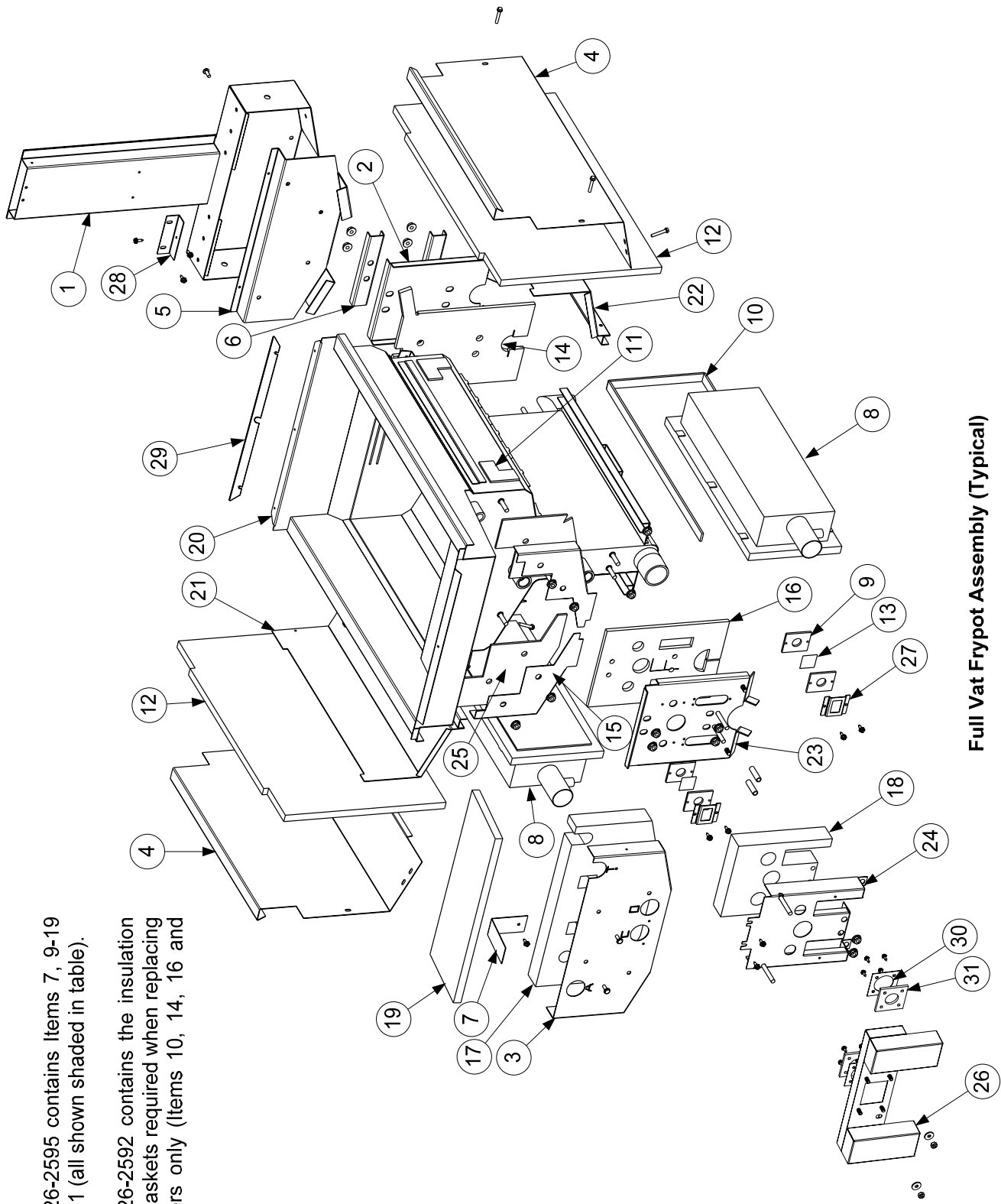

Full Vat Frypot Assembly (Typical)

ITEM	PART #	COMPONENT
	108-0857SP	Frypot Assembly Full-Vat LOV™ HE (NAT)
	108-0858SP	Frypot Assembly Full-Vat LOV™ HE (PRO)
	826-2595	Insulation Kit, Complete Full-Vat
	826-2592	Insulation Kit, Burner Full-Vat
1	108-0925	Flue Assembly, Full-Vat
2	220-6470	Back, Lower Full-Vat Combustion Chamber
3	220-6529	Retainer, Full-Vat Upper Insulation
4	220-6664	Retainer, Outer Frypot
5	230-6960	Plate, FV Collector Mounting
6	220-2851	Brace, FV Rear Insulation
7	220-2920	Brace, Foam Deck Insulation
√ 8	810-3435	Burner, Universal Replacement LOV™
9	812-0356	Insulation, Burner Sight Glass
10	812-0357	Insulation, Burner
11	812-0706	Insulation, Upper Burner Rail
12	812-1029	Insulation, Combustion Chamber Side
13	814-0048SP	Glass, Burner Sight
14	816-0837	Insulation, FV Rear Lower
15	816-0731	Insulation, FV LH/RH Front Seal
16	816-0732	Insulation, FV Lower Inner Front
17	816-0733	Insulation, FV Front Upper
18	816-0839	Insulation, FV Outer Front
19	816-0746	Insulation, Foam Deck
20	823-7283	Frypot, FV LOV™ 30 439 SS
21	823-7454	Retainer, FV LH Upper Burner
22	823-7455	Retainer, FV RH Upper Burner
23	823-7279	Retainer, FV Front Insulation
24	823-7415	Retainer, FV Outer Front
25	816-0731	Front Seal W/A
26	823-6660	Plenum, Full-Vat LOV™ ( <i>use 823-6940 for CE units</i> )
27	900-1031	Retainer, Burner Sight Glass
28	930-0818	Bracket, Flue to Pot
29	900-4253	Strip, Fluecap Retainer
30	900-1049	Retainer, Plenum Gasket
31	816-0057	Gasket, Plenum
*	816-0059	Gasket, Ignitor
*	910-2474	Pot-to-Pot Gap Clip

\* Not illustrated.

√ Recommended parts.

Kit 826-2596 contains items 6, 9-20 and 32 (all shown shaded in table).

Kit 826-2593 contains the insulation and gaskets required when replacing burners only (items 10, 14, 16 and 32).

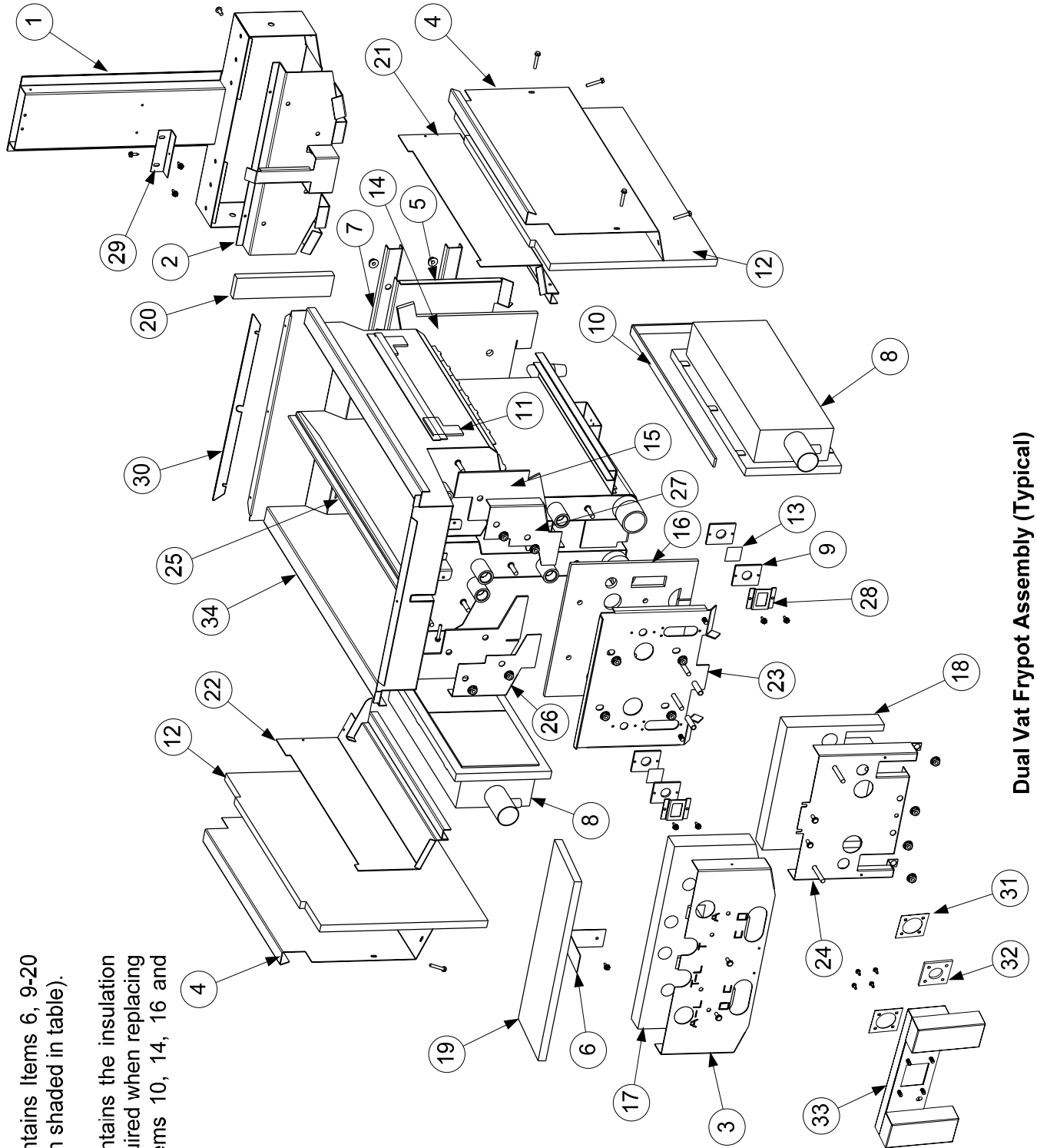

Dual Vat Frypot Assembly (Typical)

ITEM	PART #	COMPONENT
*	108-0859SP	Frypot Assembly Dual-Vat w/RF HE (NAT)
*	108-0860SP	Frypot Assembly Dual-Vat w/RF HE (PRO)
*	826-2596	Insulation Kit, Complete Dual-Vat
*	826-2593	Insulation Kit, Burner Dual-Vat
1	108-0926	Flue Assembly, Dual-Vat
2	106-7960	Plate Assembly, Dual-Vat Collector
3	220-6530	Retainer, Dual-Vat Upper Insulation
4	220-6665	Retainer, Dual-Vat Outer Frypot
5	220-6180	Back, Dual-Vat Lower Combustion Chamber
6	220-2920	Brace, Foam Deck Insulation
7	220-2972	Brace, Dual-Vat Rear Insulation
√ 8	810-3435	Burner, Universal Replacement
9	812-0356	Insulation, Burner Sight Glass
10	812-0357	Insulation, Burner
11	812-0706	Insulation, Upper Burner Rail
12	812-1029	Insulation, Combustion Chamber Side
13	814-0048SP	Glass, Burner Sight
14	816-0838	Insulation, Dual-Vat Rear Lower
15	816-0741	Insulation, Dual-Vat LH/RH Front Seal
16	816-0742	Insulation, Dual-Vat Lower Inner Front
17	816-0743	Insulation, Dual-Vat Front Upper
18	816-0840	Insulation, Dual-Vat Outer Front
19	816-0746	Insulation, Foam Deck
20	812-0688	Insulation, Flue Collection
21	823-7457	Retainer, Dual-Vat RH Upper Burner
22	823-7456	Retainer, Dual-Vat LH Upper Burner
23	823-7416	Retainer, Dual-Vat Front Insulation
24	823-7417	Retainer, Dual-Vat Outer Front
25	824-1796	Riser W/A Dual-Vat Pot
26	824-1828	Dual-Vat LH Upper W/A Seal
27	824-1829	Dual-Vat RH Upper W/A Seal
28	900-1031	Retainer, Sight Glass
29	930-0818	Bracket, Flue to Pot
30	900-4253	Strip, Fluecap Retainer
31	900-1049	Retainer, Plenum Gasket
32	816-0057	Gasket, Plenum
*	816-0059	Gasket, Ignitor
33	823-6659	Plenum, Dual-Vat LOV™ ( <i>use 823-6939 for CE units</i> )
34	823-7288	Frypot, Dual-Vat LOV™ 30 439 SS
*	910-2474	Pot-to-Pot Gap Clip

\* Not illustrated.

√ Recommended parts.